



JÖNKÖPING UNIVERSITY

IT Helpdesk
Jönköping University

Manual
Created by bria 2018-12-18
Translated by pr 2019-01-28
Changed 2021-09-16

Adobe Creative Cloud – Named User License

1. Download the Creative Cloud desktop app from Adobe:

<https://creative.adobe.com/products/download/creative-cloud>

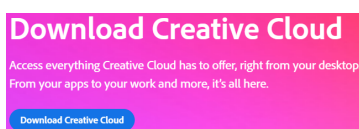

2. In Adobe Creative Cloud Installer, fill in your JU e-mail address and click in the password field to advance to the login page of JU.

A screenshot of the Adobe Creative Cloud sign-in page. The page has a white background with a dark border. At the top, it says "Sign in" in large black font. Below that, it says "New user? [Create an account](#)". There is a text input field labeled "Email address" containing the text "ture.testsson@ju.se". To the right of the input field is a blue button with the text "Continue". Below the input field and button, there is a horizontal line with the word "Or" in the center, indicating an alternative login method.

3. If "Choose an account for ..." is displayed, select Company or School account

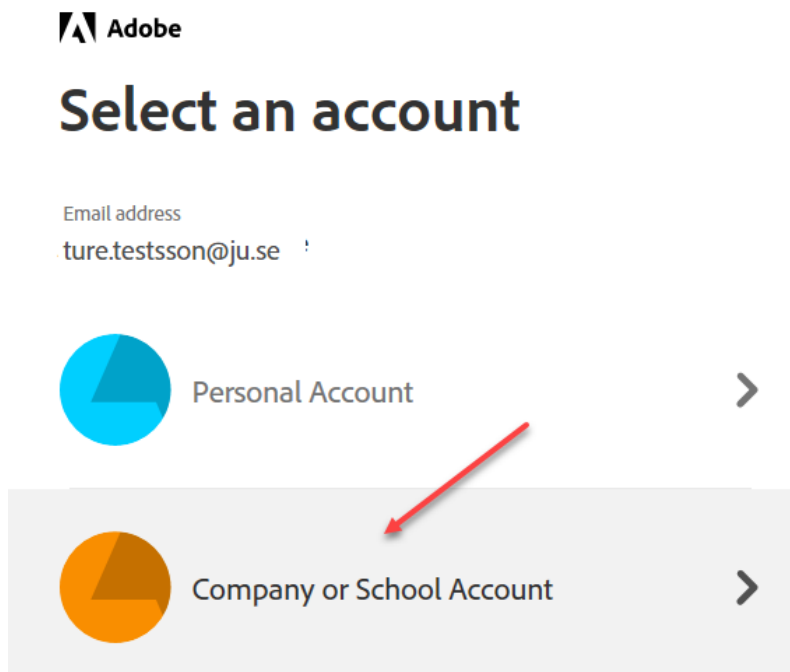

4. Sign in with your JU credentials when the JU login page appears.

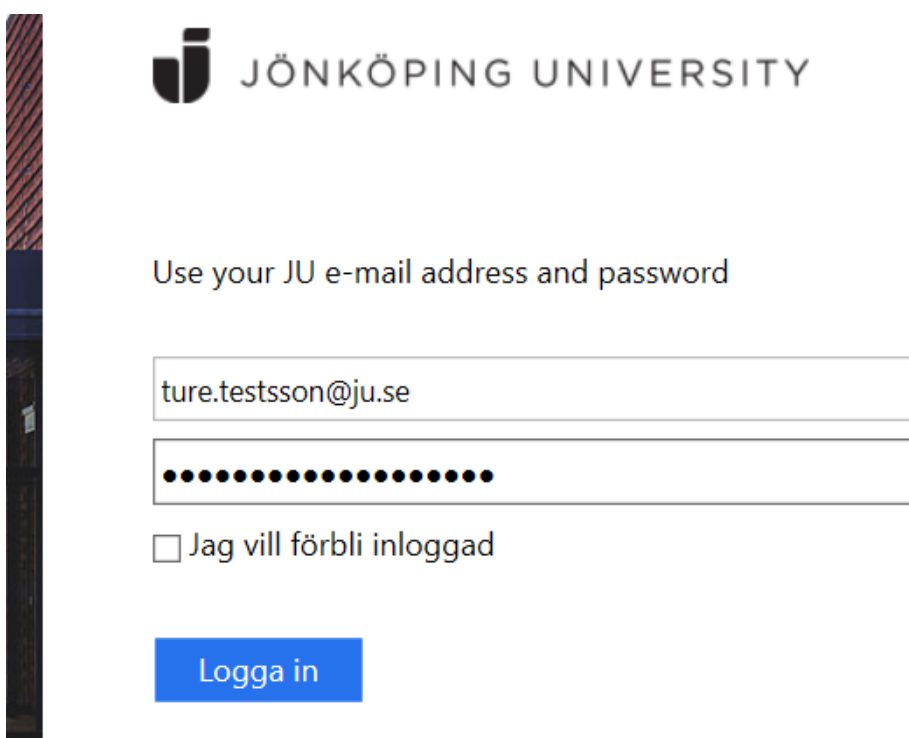

5. In the Creative Cloud desktop app, click Install for the Adobe applications you want to use. When the installation is complete, select Open to start. Shortcuts to the programs are also added to the Start menu.

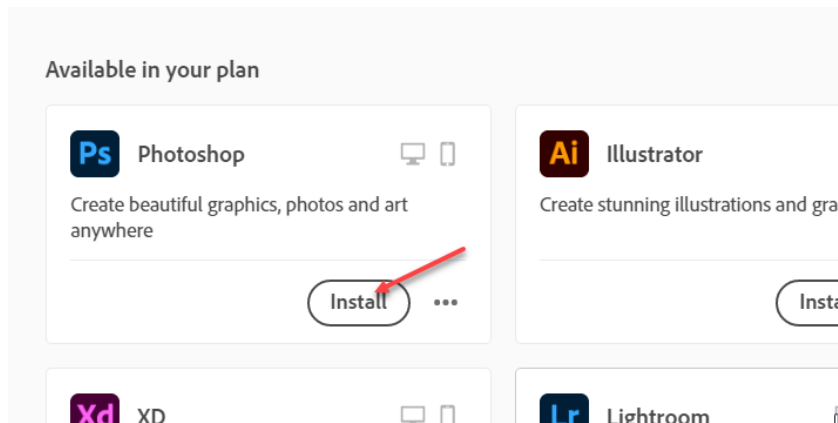

6. If you want Adobe products in Swedish or another language, click on the three "dots" in the corner next to an app, choose Other Versions > Languages. Here you will also find older versions